



Chick-fil-A

Chick-fil-A  
5200 Buffington Road  
Atlanta, Georgia 30349-2998

GBC DESIGN, INC.  
565 White Pond Dr. Akron, OH 44320-1123  
Phone 330-836-0228 Fax 330-836-5782

CHICK-FIL-A  
CHAPEL HILL UNIVERSITY PLACE FSU  
CHAPEL HILL, NC

FSU# 04954

REVISION SCHEDULE  
NO. DATE DESCRIPTION

GBC PROJECT # 54053D  
PRINTED FOR  
DATE 1/5/22  
DRAWN BY BAW

Information contained on this drawing and in all digital files provided for above named project may not be reproduced in any manner without express written or verbal consent from authorized project representatives.

SHEET  
SITE PLAN

SHEET NUMBER  
C-200

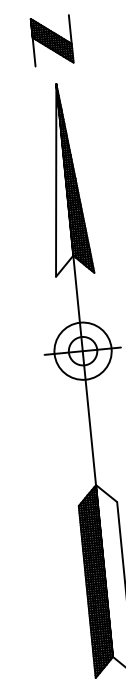

SCALE: 1" = 20'

LEGEND

- ▲ PROP. FIRE HYDRANT
- ▲ EX. FIRE HYDRANT
- PROP. VALVE
- EX. VALVE
- PROP. MANHOLE
- EX. MANHOLE
- PROP. INLET
- EX. BOX INLET
- EX. LIGHT POLE
- PROP. LIGHT POLE
- PROP. ACCESSIBLE RAMP - RAMP IS NOT TO BE SCORED OR GROOVED
- EX. CURB
- PROP. CURB & GUTTER
- PROP. ASPHALT PAVEMENT
- PROP. CONCRETE PAVEMENT/WALK
- STRIPING PER CHICK-FIL-A DUAL FLEX LANE REQUIREMENTS

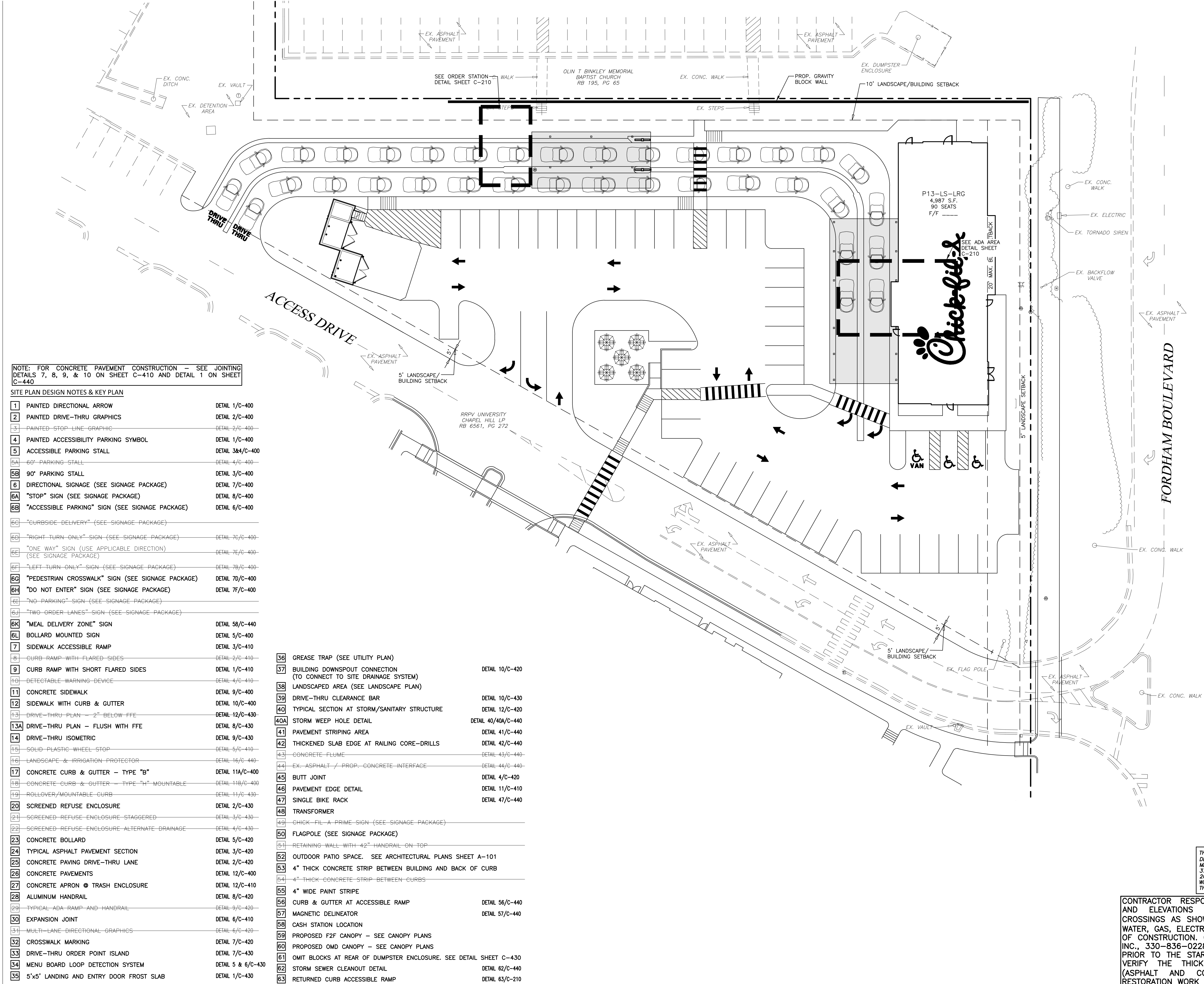

NOTE: FOR CONCRETE PAVEMENT CONSTRUCTION - SEE JOINTING DETAILS 7, 8, 9, & 10 ON SHEET C-410 AND DETAIL 1 ON SHEET C-440

SITE PLAN DESIGN NOTES & KEY PLAN

- 1 PAINTED DIRECTIONAL ARROW DETAIL 1/C-400
- 2 PAINTED DRIVE-THRU GRAPHICS DETAIL 2/C-400
- 3 PAINTED STOP LINE GRAPHIC DETAIL 2/C-400
- 4 PAINTED ACCESSIBILITY PARKING SYMBOL DETAIL 1/C-400
- 5 ACCESSIBLE PARKING STALL DETAIL 3&4/C-400
- 5A 60" PARKING STALL DETAIL 4/C-400
- 5B 90" PARKING STALL DETAIL 3/C-400
- 6 DIRECTIONAL SIGNAGE (SEE SIGNAGE PACKAGE) DETAIL 7/C-400
- 6A "STOP" SIGN (SEE SIGNAGE PACKAGE) DETAIL 8/C-400
- 6B "ACCESSIBLE PARKING" SIGN (SEE SIGNAGE PACKAGE) DETAIL 6/C-400
- 6C "CURBSIDE-DELIVERY" (SEE SIGNAGE PACKAGE)
- 6D "RIGHT TURN ONLY" SIGN (SEE SIGNAGE PACKAGE) DETAIL 7/C-400
- 6E "ONE WAY" SIGN (USE APPLICABLE DIRECTION) (SEE SIGNAGE PACKAGE) DETAIL 7E/C-400
- 6F "LEFT TURN ONLY" SIGN (SEE SIGNAGE PACKAGE) DETAIL 7B/C-400
- 6G "PEDESTRIAN CROSSWALK" SIGN (SEE SIGNAGE PACKAGE) DETAIL 7D/C-400
- 6H "DO NOT ENTER" SIGN (SEE SIGNAGE PACKAGE) DETAIL 7F/C-400
- 6I "NO PARKING" SIGN (SEE SIGNAGE PACKAGE)
- 6J "TWO ORDER LANES" SIGN (SEE SIGNAGE PACKAGE)
- 6K "MEAL DELIVERY ZONE" SIGN DETAIL 5B/C-440
- 6L BOLLARD MOUNTED SIGN DETAIL 5/C-400
- 7 SIDEWALK ACCESSIBLE RAMP DETAIL 3/C-410
- 8 CURB RAMP WITH FLARED SIDES DETAIL 2/C-410
- 9 CURB RAMP WITH SHORT FLARED SIDES DETAIL 1/C-410
- 10 DETECTABLE WARNING DEVICE DETAIL 4/C-410
- 11 CONCRETE SIDEWALK DETAIL 9/C-400
- 12 SIDEWALK WITH CURB & GUTTER DETAIL 10/C-400
- 13 DRIVE-THRU PLAN - 2" BELOW FFE DETAIL 12/C-430
- 13A DRIVE-THRU PLAN - FLUSH WITH FFE DETAIL 8/C-430
- 14 DRIVE-THRU ISOMETRIC DETAIL 9/C-430
- 15 SOLID PLASTIC WHEEL STOP DETAIL 5/C-410
- 16 LANDSCAPE & IRRIGATION PROTECTOR DETAIL 16/C-440
- 17 CONCRETE CURB & GUTTER - TYPE "B" DETAIL 11A/C-400
- 18 CONCRETE CURB & GUTTER - TYPE "H" MOUNTABLE DETAIL 11B/C-400
- 19 ROLL-OVER/MOUNTABLE CURB DETAIL 11/C-430
- 20 SCREENED REFUSE ENCLOSURE DETAIL 2/C-430
- 21 SCREENED REFUSE ENCLOSURE - STAGGERED DETAIL 3/C-430
- 22 SCREENED REFUSE ENCLOSURE - ALTERNATE DRAINAGE DETAIL 4/C-430
- 23 CONCRETE BOLLARD DETAIL 5/C-420
- 24 TYPICAL ASPHALT PAVEMENT SECTION DETAIL 3/C-420
- 25 CONCRETE PAVING DRIVE-THRU LANE DETAIL 2/C-420
- 26 CONCRETE PAVEMENTS DETAIL 12/C-400
- 27 CONCRETE APRON @ TRASH ENCLOSURE DETAIL 12/C-410
- 28 ALUMINUM HANDRAIL DETAIL 8/C-420
- 29 TYPICAL ADA RAMP AND HANDRAIL DETAIL 9/C-420
- 30 EXPANSION JOINT DETAIL 6/C-410
- 31 MULTI-LANE DIRECTIONAL GRAPHICS DETAIL 6/C-420
- 32 CROSSWALK MARKING DETAIL 7/C-420
- 33 DRIVE-THRU ORDER POINT ISLAND DETAIL 7/C-430
- 34 MENU BOARD LOOP DETECTION SYSTEM DETAIL 5 & 6/C-430
- 35 5'x5' LANDING AND ENTRY DOOR FROST SLAB DETAIL 1/C-430
- 36 GREASE TRAP (SEE UTILITY PLAN)
- 37 BUILDING DOWNSPOUT CONNECTION (TO CONNECT TO SITE DRAINAGE SYSTEM) DETAIL 10/C-420
- 38 LANDSCAPED AREA (SEE LANDSCAPE PLAN)
- 39 DRIVE-THRU CLEARANCE BAR DETAIL 10/C-430
- 40 TYPICAL SECTION AT STORM/SANITARY STRUCTURE DETAIL 12/C-420
- 40A STORM WEEP HOLE DETAIL DETAIL 40/40A/C-440
- 41 PAVEMENT STRIPING AREA DETAIL 41/C-440
- 42 THICKENED SLAB EDGE AT RAILING CORE-DRILLS DETAIL 42/C-440
- 43 CONCRETE FLUME DETAIL 43/C-440
- 44 EX. ASPHALT / PROP. CONCRETE INTERFACE DETAIL 44/C-440
- 45 BUTT JOINT DETAIL 4/C-420
- 46 PAVEMENT EDGE DETAIL DETAIL 11/C-410
- 47 SINGLE BIKE RACK DETAIL 47/C-440
- 48 TRANSFORMER
- 49 CHICK-FIL-A PRIME SIGN (SEE SIGNAGE PACKAGE)
- 50 FLAGPOLE (SEE SIGNAGE PACKAGE)
- 51 RETAINING WALL WITH 42" HANDRAIL ON TOP
- 52 OUTDOOR PATIO SPACE. SEE ARCHITECTURAL PLANS SHEET A-101
- 53 4" THICK CONCRETE STRIP BETWEEN BUILDING AND BACK OF CURB
- 54 4" THICK CONCRETE STRIP BETWEEN CURBS
- 55 4" WIDE PAINT STRIPE
- 56 CURB & GUTTER AT ACCESSIBLE RAMP DETAIL 56/C-440
- 57 MAGNETIC DELINEATOR DETAIL 57/C-440
- 58 CASH STATION LOCATION
- 59 PROPOSED F2F CANOPY - SEE CANOPY PLANS
- 60 PROPOSED OMD CANOPY - SEE CANOPY PLANS
- 61 OMIT BLOCKS AT REAR OF DUMPSTER ENCLOSURE. SEE DETAIL SHEET C-430
- 62 STORM SEWER CLEANOUT DETAIL DETAIL 62/C-440
- 63 RETURNED CURB ACCESSIBLE RAMP DETAIL 63/C-210

THIS PROPERTY IS LOCATED WITHIN AN AREA HAVING ZONE DESIGNATIONS OF "X & AE" BY THE FEDERAL EMERGENCY MANAGEMENT AGENCY, ON FLOOD INSURANCE RATE MAP NO. 3710979900L, WITH A MAP REVISED DATE OF OCTOBER 19, 2018, IN ORANGE COUNTY, STATE OF NORTH CAROLINA, WHICH IS THE CURRENT FLOOD INSURANCE RATE MAP FOR THE COMMUNITY IN WHICH SAID PROPERTY IS SITUATED.

CONTRACTOR RESPONSIBLE TO FIELD VERIFY LOCATIONS AND ELEVATIONS OF EXISTING UTILITY TIE-INS AND CROSSINGS AS SHOWN ON SITE PLANS (SANITARY, STORM, WATER, GAS, ELECTRIC, PHONE, ETC.) PRIOR TO THE START OF CONSTRUCTION. CONTACT ALLAN WILEY AT GBC DESIGN, INC., 330-836-0228, WITH ANY CONCERNS OR CONFLICTS PRIOR TO THE START OF CONSTRUCTION. CONTRACTOR TO VERIFY THE THICKNESS OF ANY OFF-SITE PAVEMENT (ASPHALT AND CONCRETE) AND SIDEWALK SO THE RESTORATION WORK IS INCLUDED IN THE BID.